



Air Transport Assn.



WebCGM

The Choice for Technical Illustrations

Presented at XML Europe 2001

Berlin, Germany

May 24, 2001

 **UNITED AIRLINES**
andy.dewild@ual.com

 **BOEING**
david.w.cruikshank@boeing.com

Agenda

- **Requirements - an historical perspective**
 - **Interchange**
 - **Reuse**
 - **Intelligent graphics**
- **Web delivery of vector graphics**
 - **WebCGM**
 - **SVG**
- **Conclusion**

Requirements

Technical illustrations

- **Complex line art**
- **Large volume of illustrations**
- **Long life cycle**
- **Frequent revisions**
- **Reused in different applications**

Requirements - interchange

The way it was internally

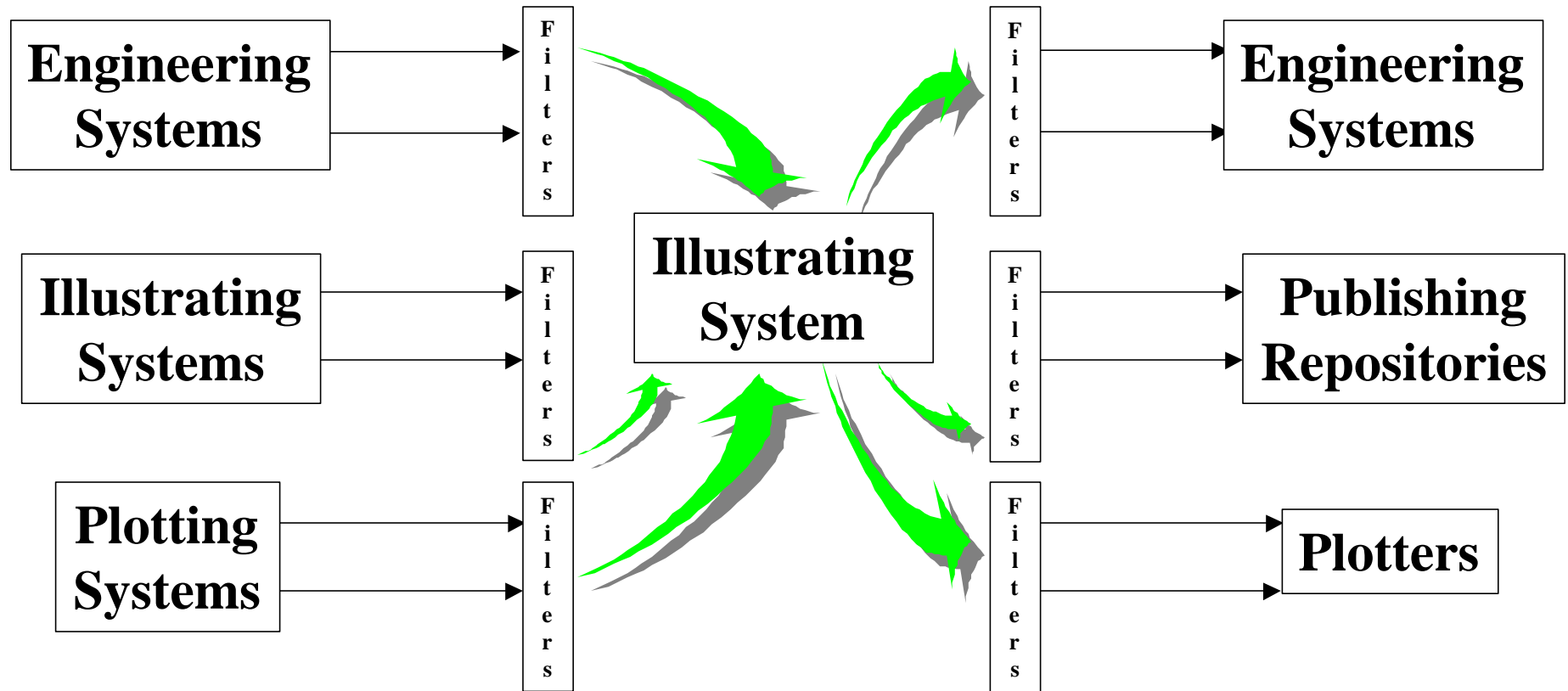

Requirements - interchange

Internal

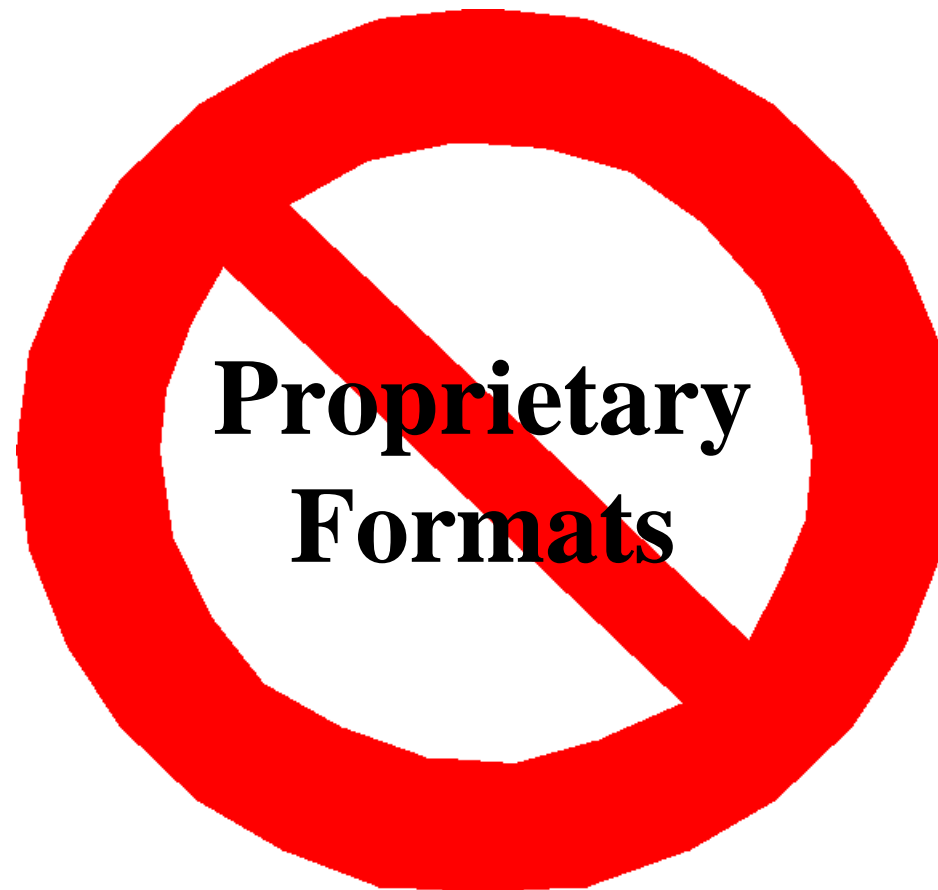

Requirements - interchange

The way it is now internally

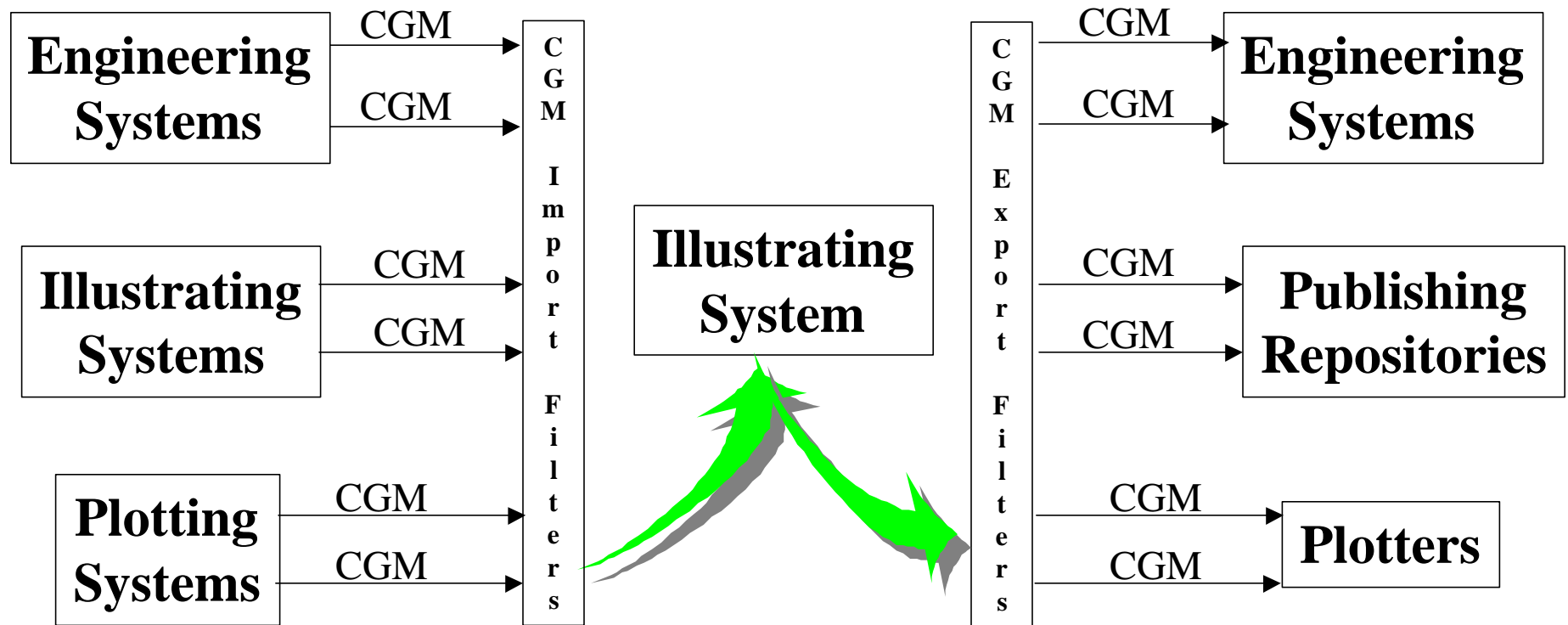

Requirements - interchange

The way it was (heading) externally

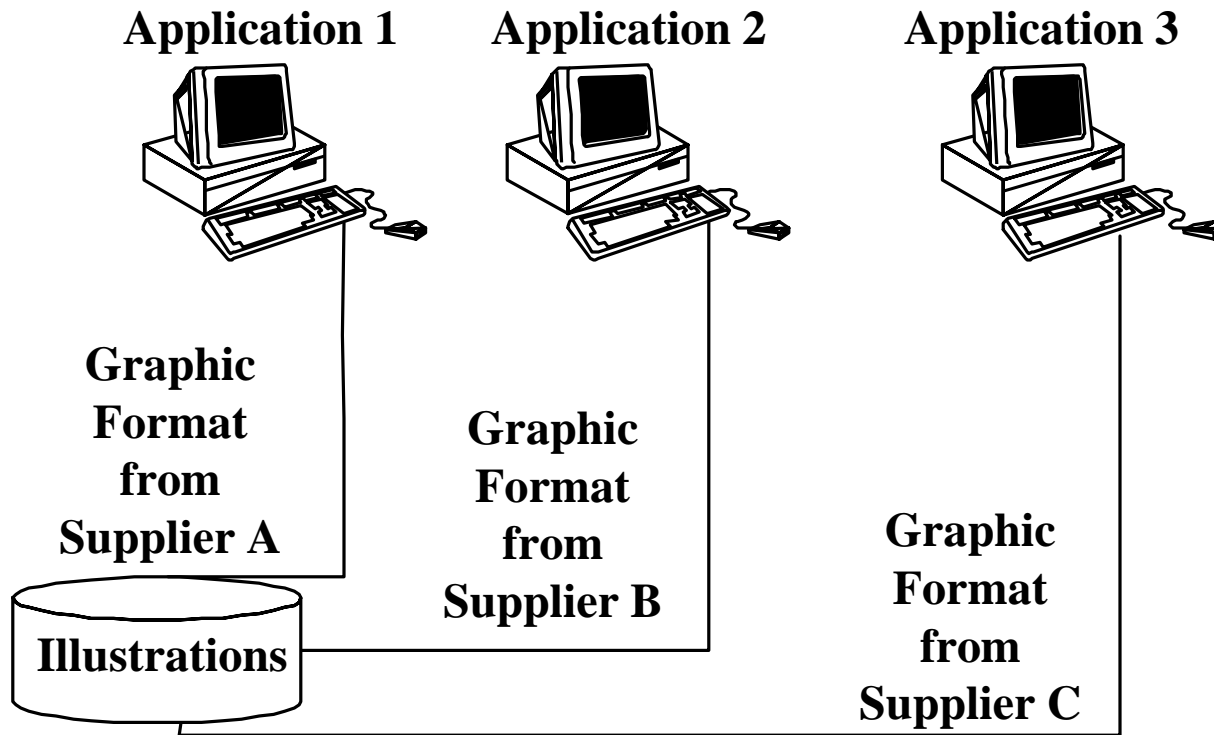

Requirements - interchange

External

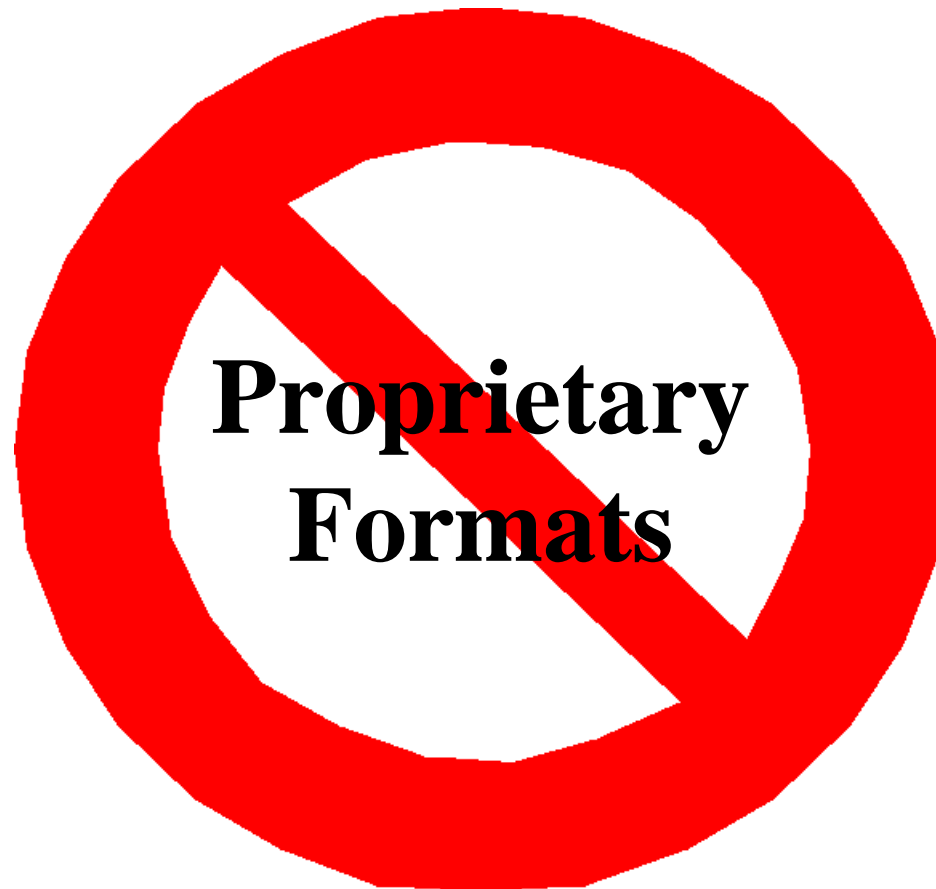

Requirements - interchange

The way it is now externally

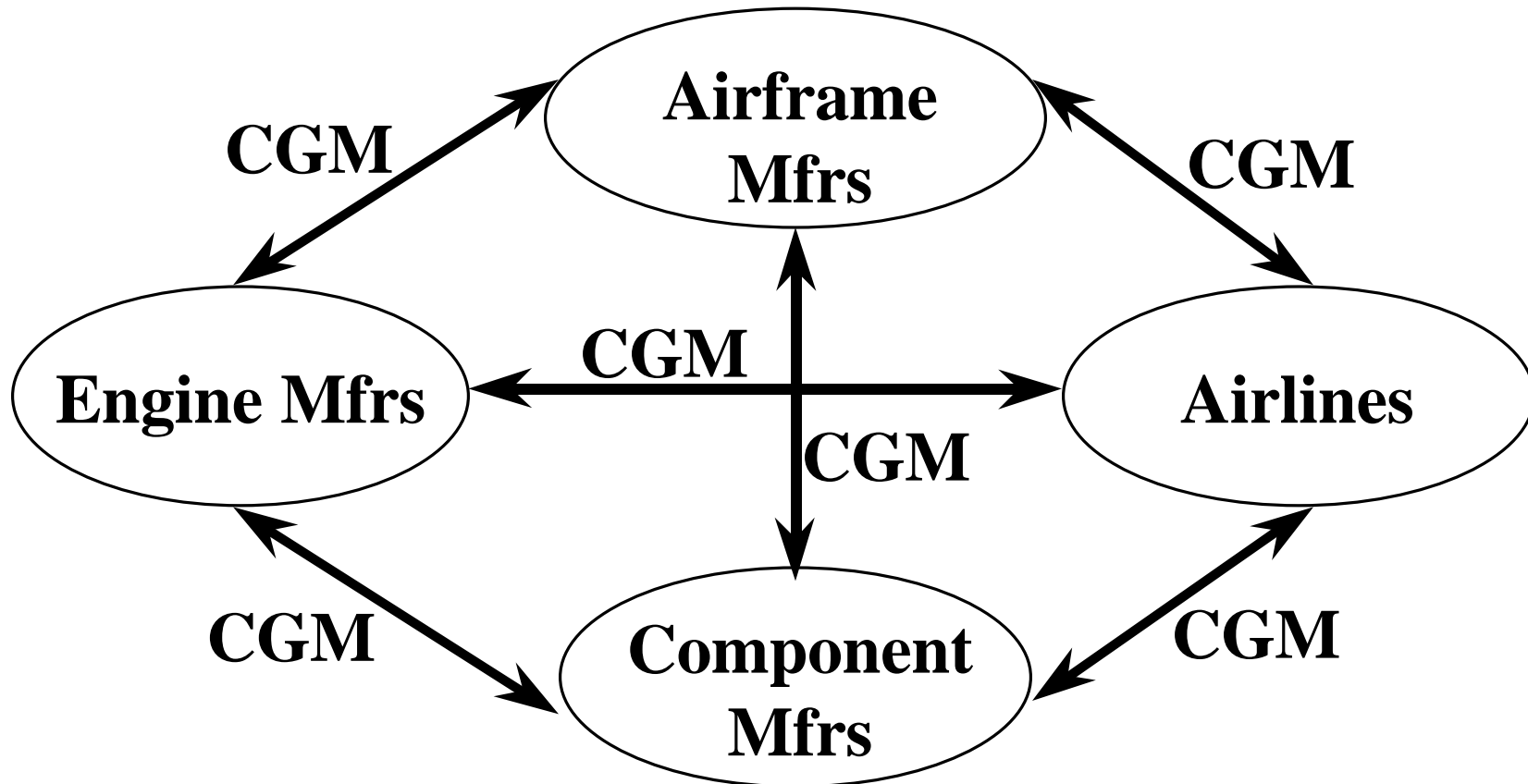

Requirements - reuse

Manufacturers

Editing for
reuse

Authoring

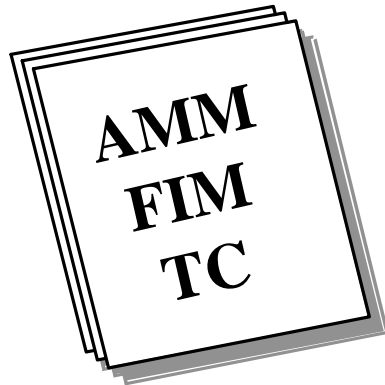

Multiple models
Multiple documents

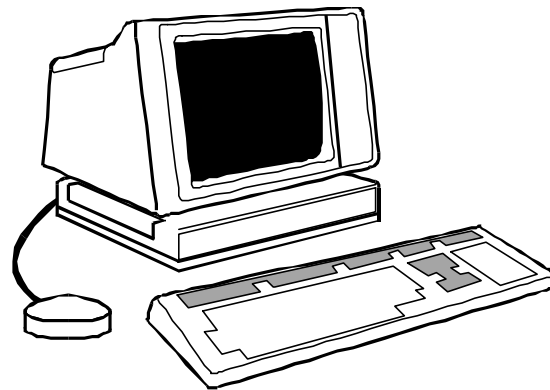

Illustrating
systems

Manufacturing

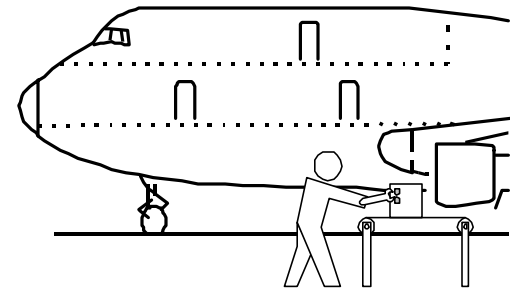

Requirements - reuse

Airlines

Editing for reuse

Maintenance procedures

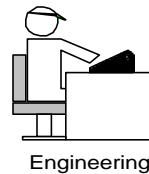
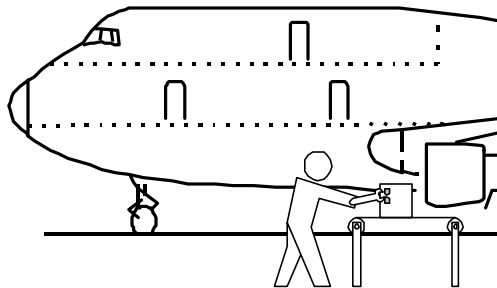

Equipment Mods

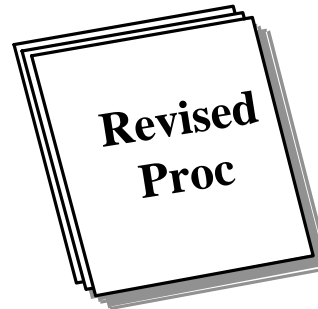

Internal documentation



Requirements

Intelligent graphics

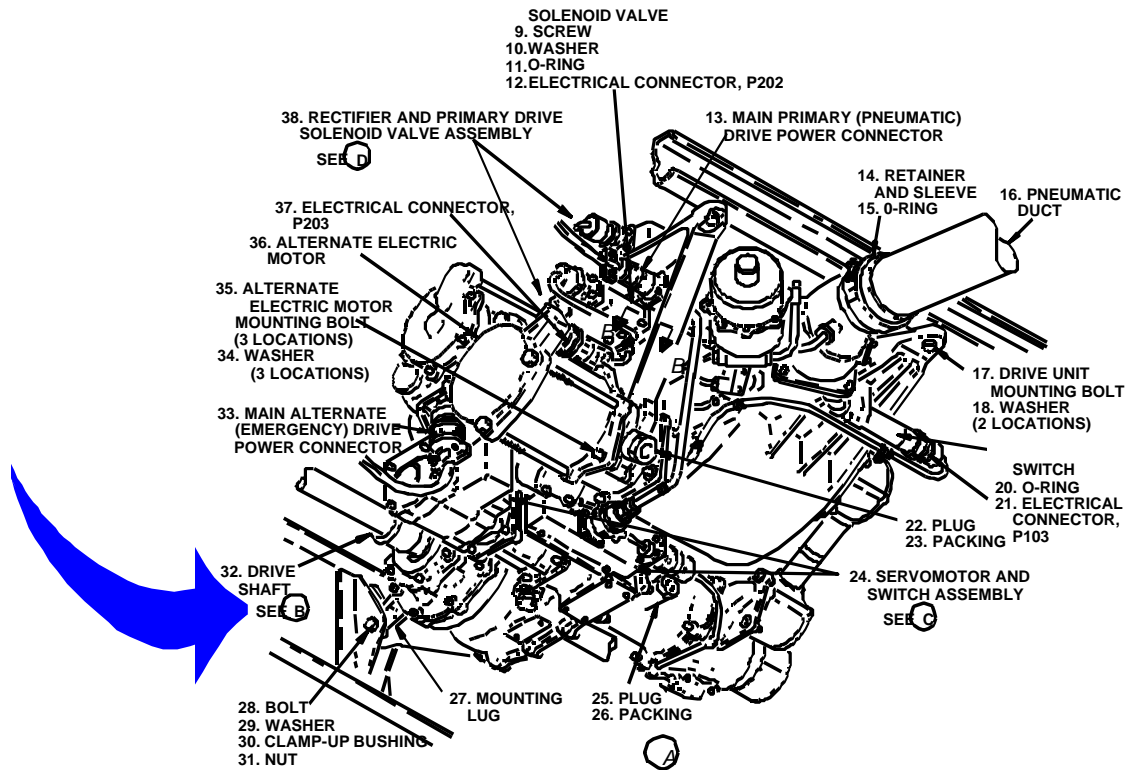

Power Drive Unit and Components Installation
Figure 201 (Sheet 1)

Requirements

Intelligent graphics

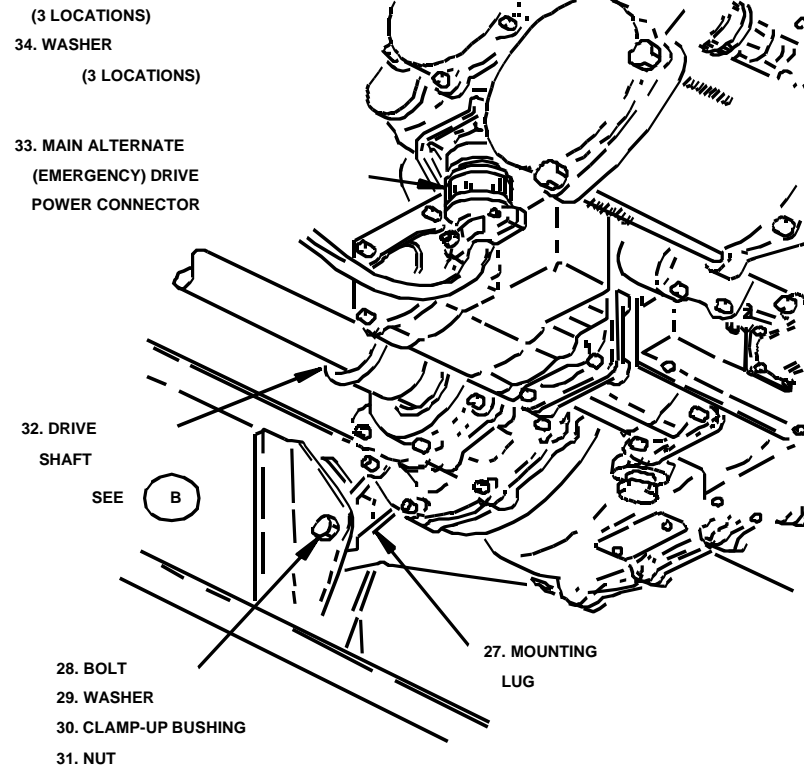

Requirements

Intelligent graphics

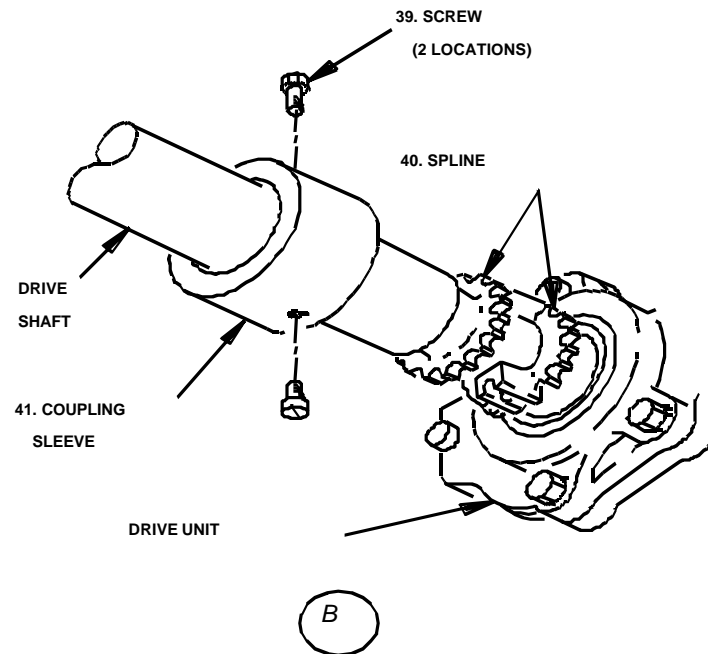

Requirements

Intelligent graphics

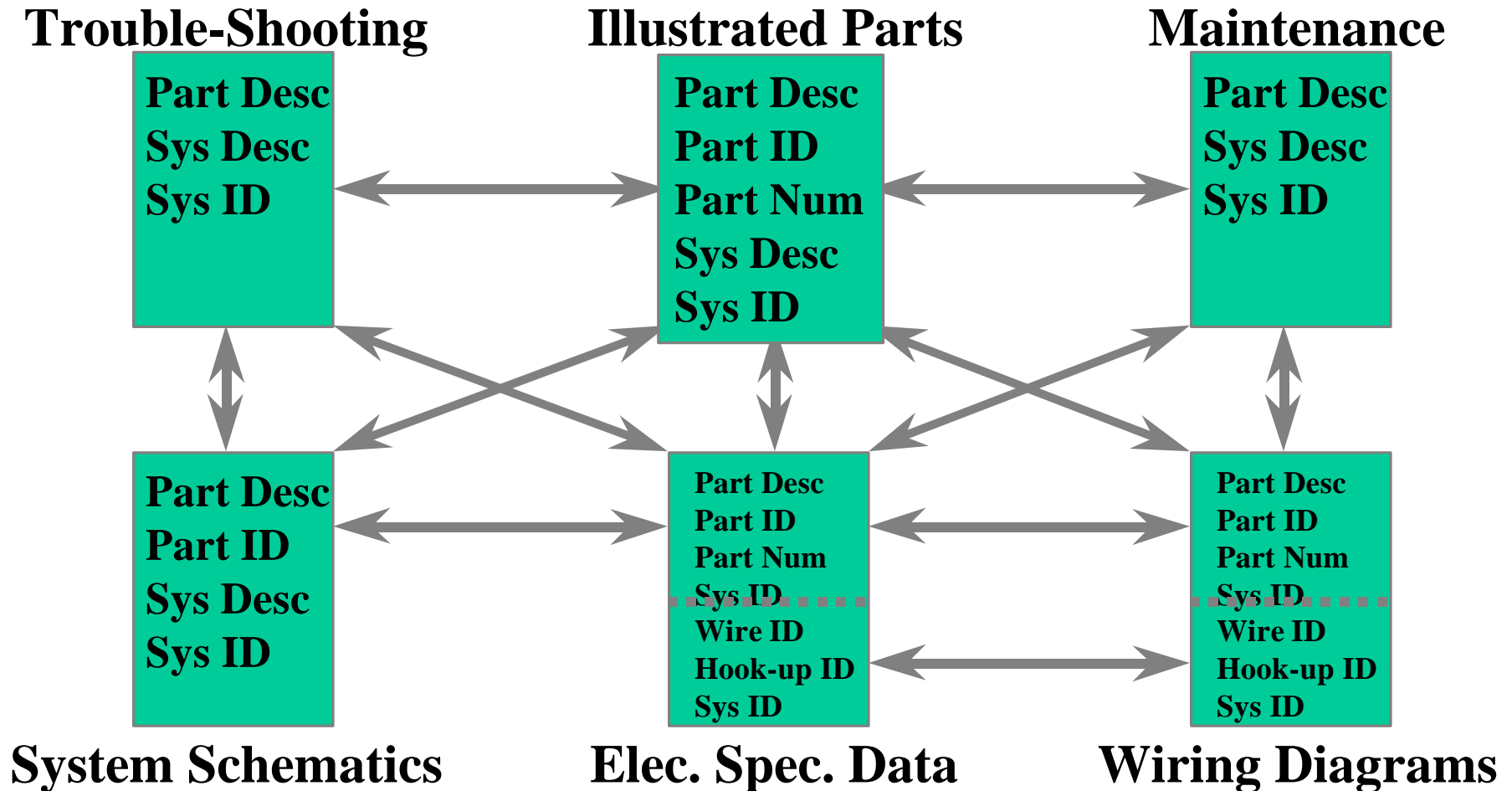

Requirements

Solution



Air Transport Assn.

- **ATA Spec 2200 Graphics GREXCHANGE**
 - Graphics interchange with CGM V4 support
- **ATA Spec 2200 Graphics IGEXCHANGE**
 - Intelligent graphics interchange with CGM V4 model

Web delivery Model

Manufacturers

Airlines

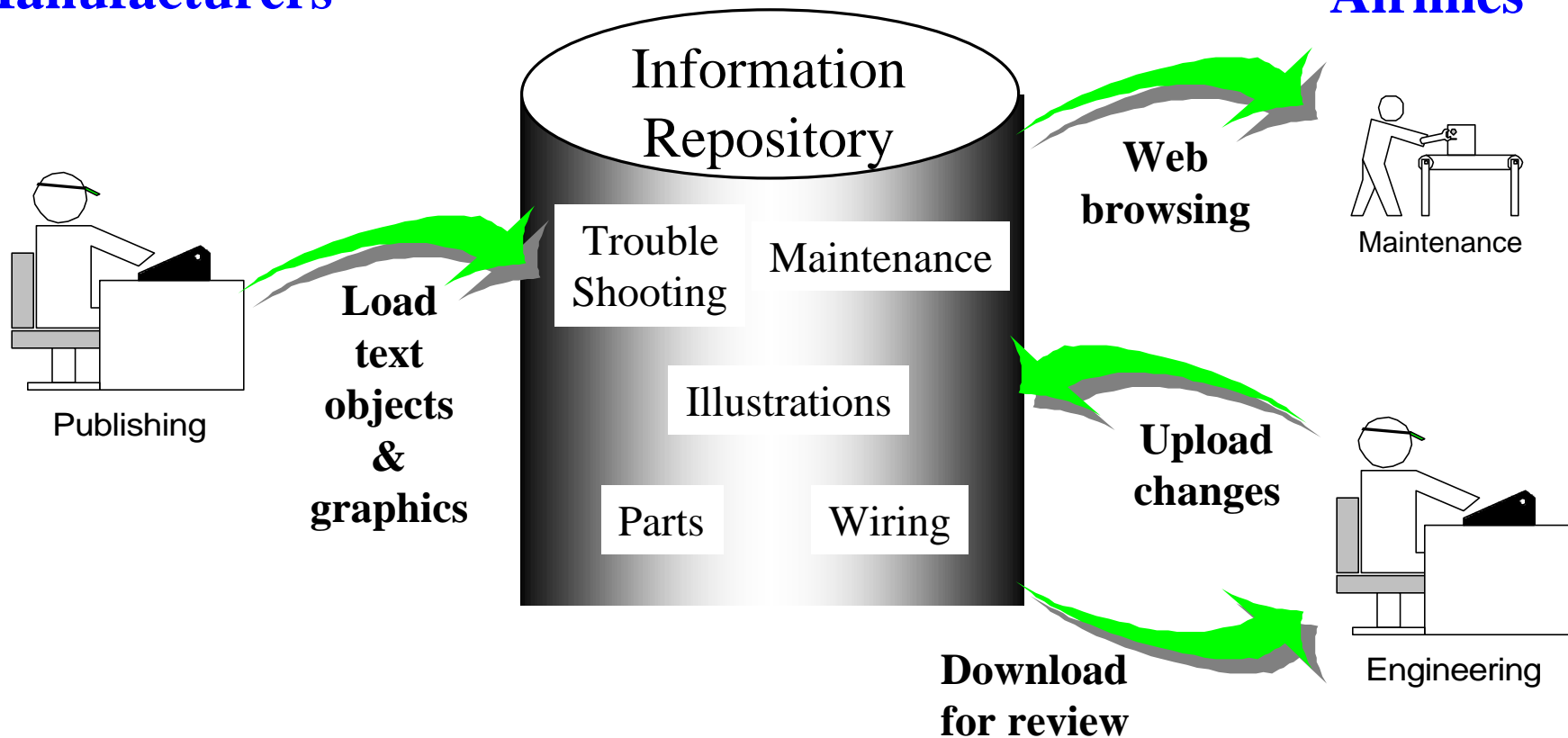



Web delivery

Vector formats - WebCGM



- **Based on ATA GREXANGE**
 - Tailored to technical documentation
 - ATA navigation requirements
 - ATA reuse requirements
- **Collaborative effort between CGM Open and W3C graphics expertise**



Web delivery

WebCGM - W3C history



- **1995 - CGM became a registered mime type**
- **1996 - W3C published “Scalable Graphics Requirements”**
- **1997 - W3C published “Use of CGM as a Scalable Graphic Format”**
- **1999 - WebCGM 1.0 approved in January**
- **2001 - WebCGM 1.0 Release 2 (watch this space)**



Web delivery

Vector formats - SVG

- **Developed as a new effort**
 - Wide range of application support
 - Integrated, dynamic, animated websites
 - XML tagset and fully stylable
- **W3C sponsored collaborative activity with wide vendor participation**

Web delivery

SVG - W3C history

- **1996 - W3C published “Scalable Graphics Requirements”**
- **1998 - SVG committee convened**
- **1999 - First draft of SVG**
- **2000 - W3C candidate recommendation**
- **2001 - Awaiting recommendation status**

Summary

- WebCGM

- ⇒ Profile of established ISO Standard
- ⇒ Based on years of industry use in ATA
- ⇒ Editors/plugins/applications available

- SVG

- ⇒ W3C candidate recommendation
- ⇒ Newly developed technology
- ⇒ Editors/plugins/applications available

Summary

Lets try some viewing

Technical illustrations

Review

- **Complex line art**
- **Large volume of illustrations**
- **Long life cycle**
- **Frequent revisions**
- **Reused in different applications**

Conclusion

WebCGM